

ZOELLER
PUMP COMPANY



Trusted. Tested. Tough.®

zoellerpumps.com



MODEL 63

Premium Sump Pump

Added features when it positively has to be the best.



Zoeller Family of Water Solutions™

Copyright Zoeller Co. All rights reserved.

FM2959
0724
Supersedes
0624

Features:

- 5-year warranty
- Advanced switch technology allowing longer switch life (available in automatic only)
- 3/10 HP Premium 115 V sump pump
- Performance up to 19.25' (5.9 m) TDH
- Flows up to 43 GPM (163 LPM)
- Green LED plug showing power to the pump
- Viton switch arm boot and heavy-duty rubber power cord for longevity and durability
- All cast iron construction for a more robust pump
- Corrosion-resistant, powder coated epoxy paint

100% factory tested

PRODUCT SPECIFICATIONS

MOTOR	Horse Power	3/10
	Voltage	115
	Phase	1 Ph
	Hertz	60 Hz
	RPM	1550
	Type	Shaded pole
	Insulation	Class B
	Amps	9.7
PUMP	Operation	Automatic
	Auto On/Off Points	7-1/4" (18.4 cm) / 3" (7.6 cm)
	Discharge Size	1-1/2" NPT
	Solids Handling	1/2" (12 mm) spherical solids
	Cord Length	10' (3.1 m)
	Cord Type	UL listed, 3-wire, grounded plug
	Max. Head	19.25' (5.9 m)
	Max. Flow Rate	43 GPM (163 LPM)
	Max. Operating Temp.	130 °F (54 °C)
	Cooling	Oil filled
MATERIALS	Motor Protection	Auto reset thermal overload
	Cap	Cast iron
	Motor Housing	Cast iron
	Pump Housing	Cast iron
	Base	Cast iron (optional - Engineered Synthetic)
	Upper Bearing	Sleeve bearing
	Lower Bearing	Sleeve bearing
	Mechanical Seals	Carbon and ceramic
	Impeller Type	Non-clogging vortex
	Impeller	Cast iron (optional - Engineered Synthetic)
	Hardware	Stainless steel
	Motor Shaft	AISI 1215 cold rolled steel
	Gasket	Neoprene

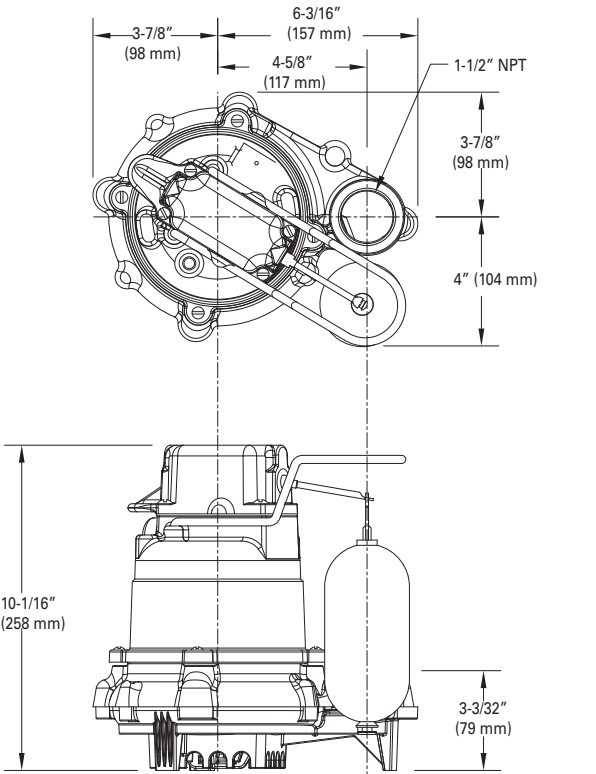

SK858

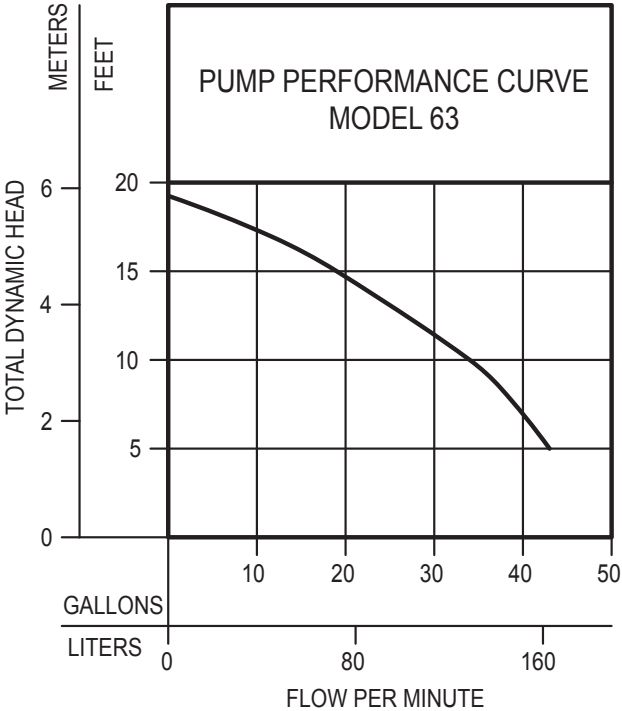

CAUTION All installation of controls, protection devices and wiring should be done by a qualified licensed electrician. All electrical and safety codes should be followed including the most recent National Electrical Code (NEC) and the Occupational Safety and Health Act (OSHA).